

CONTRACTOR NOTE:
 ALL WALLS ARE TO BE PLUMB
 & LEVEL. INSTALLER TO USE
 NECESSARY SHIMS IF WALLS
 ARE NOT PLUMB OR LEVEL.
 SHIMS (NOT BY ESTOLGA)

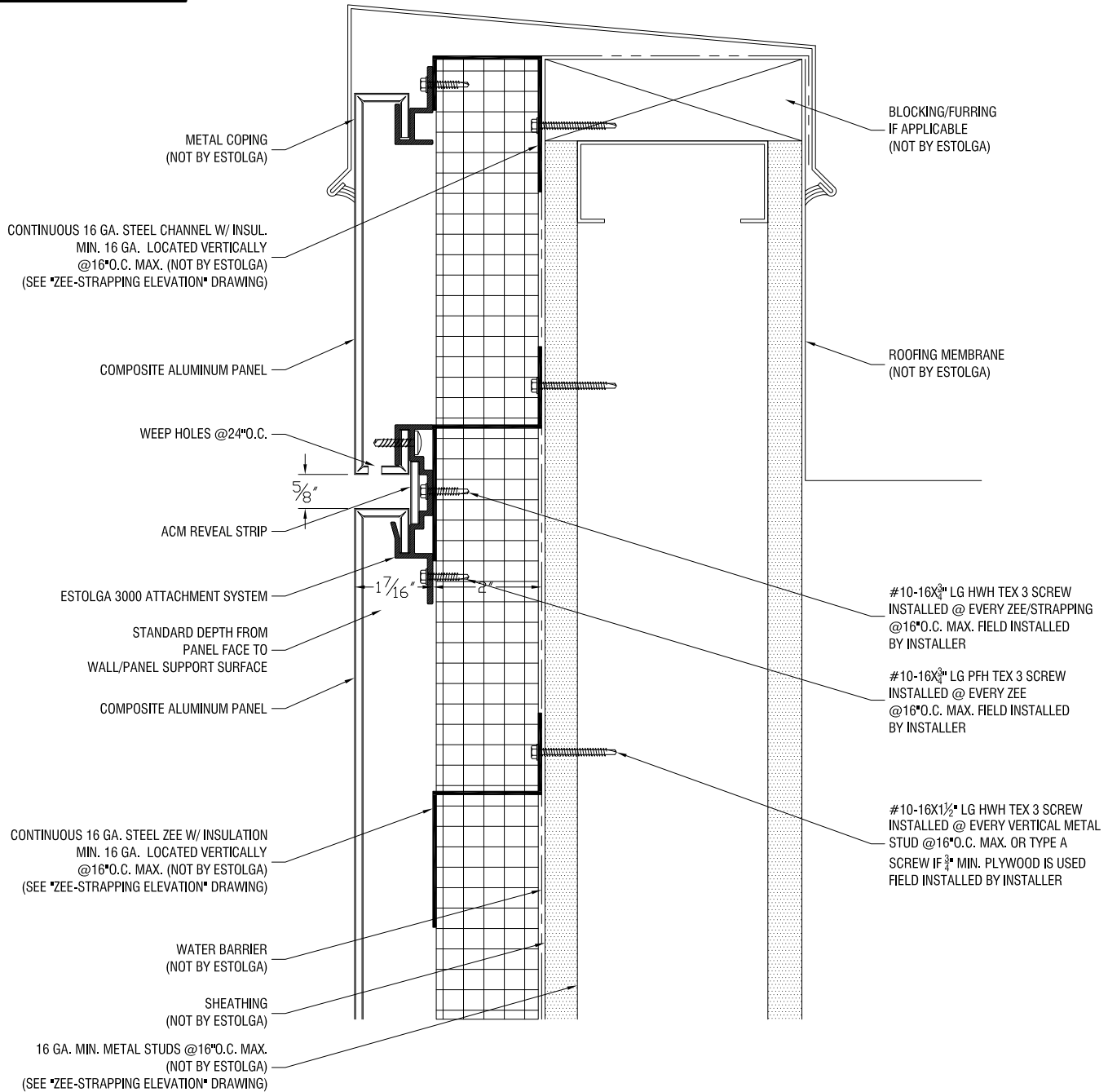

Coping Detail-1

ESTOLGA 3000 AAMA 508 PRESSURE EQUALIZED RAINSCREEN SYSTEM (SYSTEM INSTALLED ON CONTINUOUS ZEE W/ INSULATION)

TO PURCHASE ENGINEERED/FABRICATED PANEL SYSTEM, CONTACT ALLIED METAL: (888) 520-8800

TO PURCHASE ENGINEERED ESTOLGA ATTACHMENT SYSTEMS CONTACT WRISCO: (800)753-9400

TESTED ASTM E-330, ASTM E-331, ASTM E-283, AAMA-508

PATENTED PRODUCTS 7.621.084, 084 B2, 7.472.521, 521 B2, 8.127.507, 8.015.917 PATENT PENDING, DESIGN PATENT PENDING



ALLIED[®]
 SPECIALTY GROUP

CONTRACTOR NOTE:
 ALL WALLS ARE TO BE PLUMB
 & LEVEL. INSTALLER TO USE
 NECESSARY SHIMS IF WALLS
 ARE NOT PLUMB OR LEVEL.
 SHIMS (NOT BY ESTOLGA)

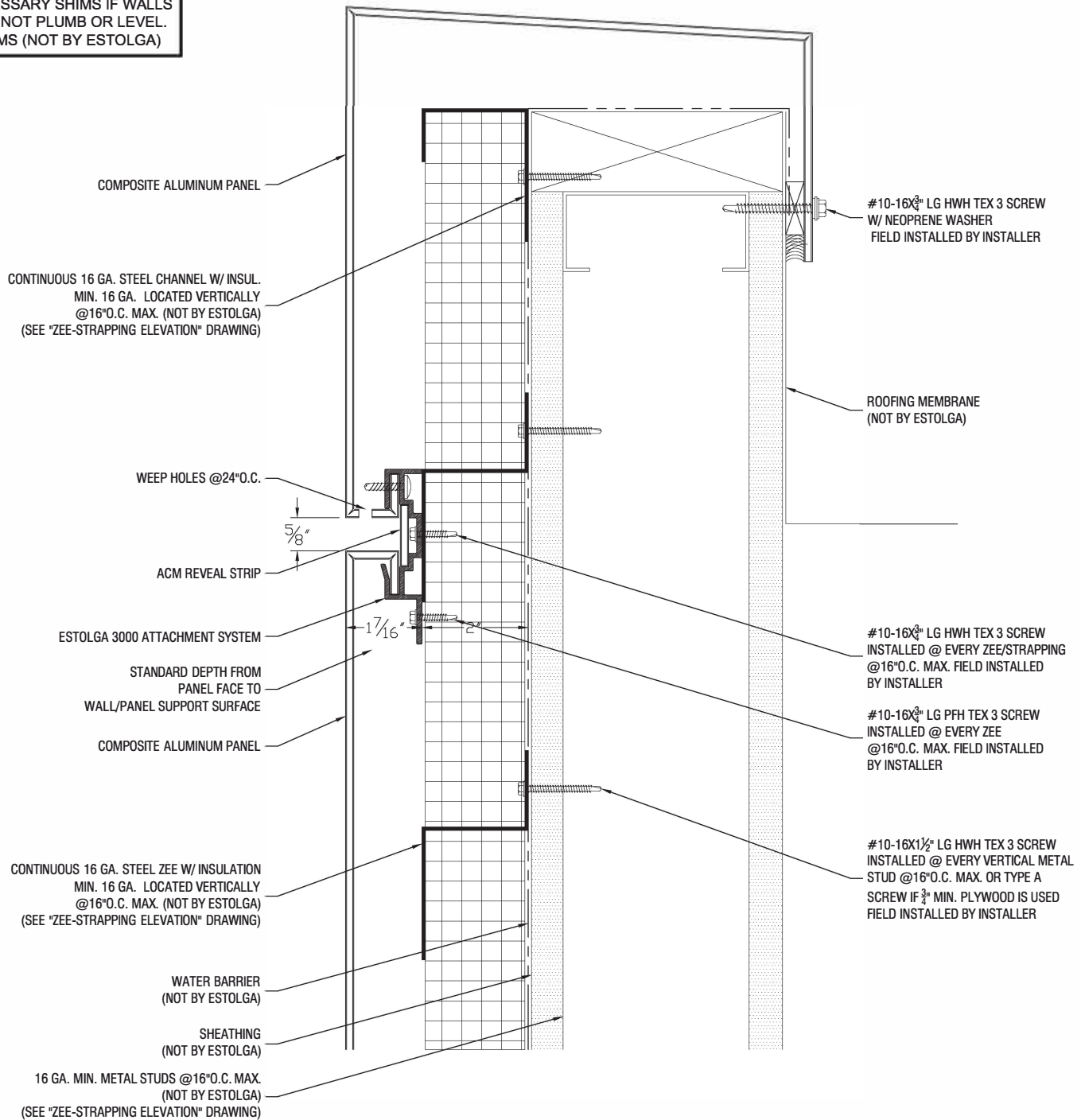

Coping Detail-2

**ESTOLGA 3000 AAMA 508 PRESSURE
 EQUALIZED RAINDSCREEN SYSTEM
 (SYSTEM INSTALLED ON CONTINUOUS ZEE W/ INSULATION)**

TO PURCHASE ENGINEERED/FABRICATED PANEL SYSTEM, CONTACT ALLIED METAL: (888) 520-8800

TO PURCHASE ENGINEERED ESTOLGA ATTACHMENT SYSTEMS CONTACT WRISCO: (800)753-8400

TESTED ■ ASTM E-330, ASTM E-331, ASTM E-283, AAMA-508

PATENTED PRODUCTS 7.621.084, 084 B2, 7.472.521, 521 B2, 8.127.507, 8.015.917 PATENT PENDING, DESIGN PATENT PENDING



ALLIED[®]
 SPECIALTY GROUP

CONTRACTOR NOTE:
 ALL WALLS ARE TO BE PLUMB
 & LEVEL. INSTALLER TO USE
 NECESSARY SHIMS IF WALLS
 ARE NOT PLUMB OR LEVEL.
 SHIMS (NOT BY ESTOLGA)

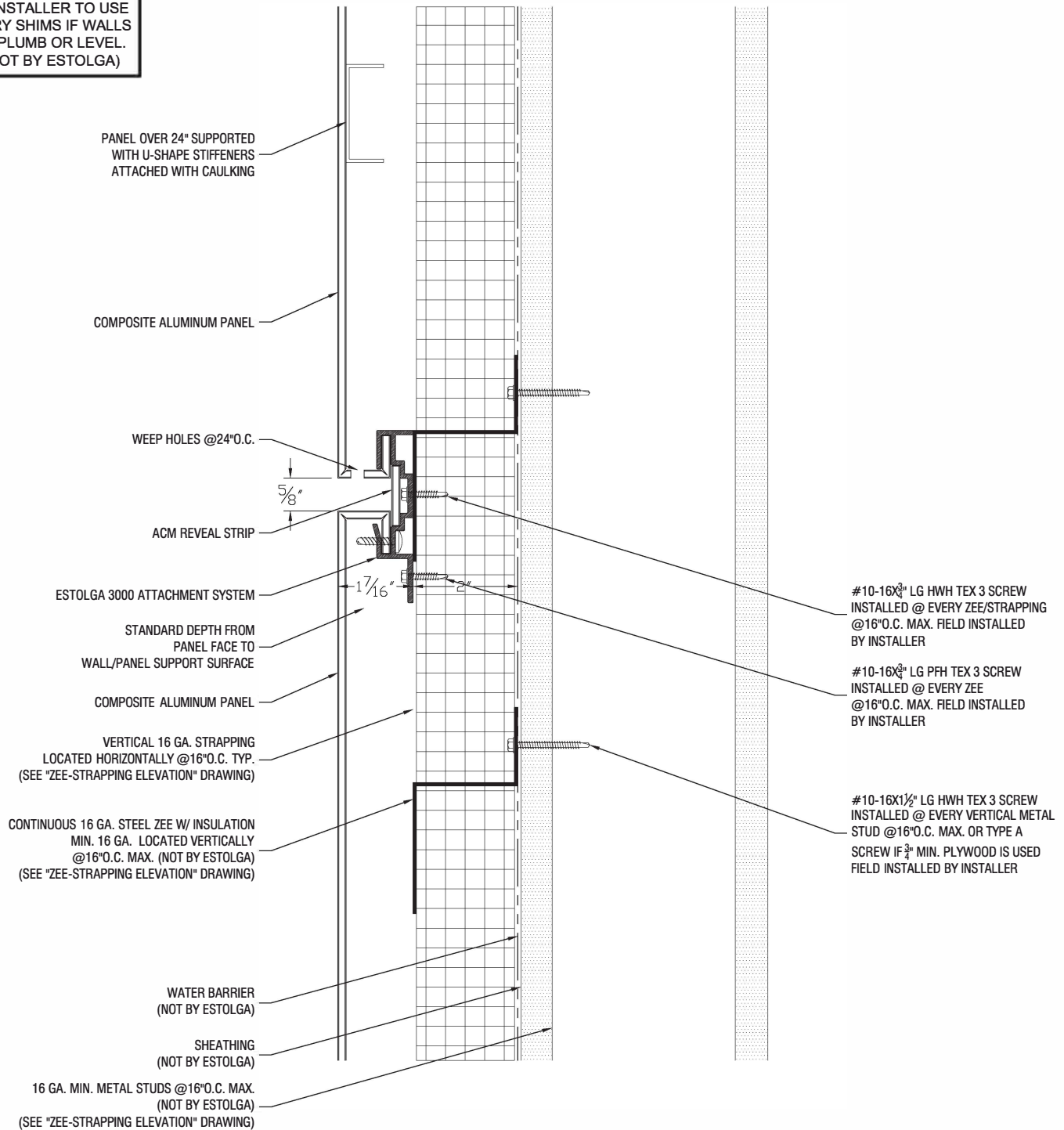

Typical Horizontal Joint Detail

**ESTOLGA 3000 AAMA 508 PRESSURE
 EQUALIZED RAINDRAIN SYSTEM
 (SYSTEM INSTALLED ON CONTINUOUS ZEE W/ INSULATION)**



ALLIED[®]
 SPECIALTY GROUP

TO PURCHASE ENGINEERED/FABRICATED PANEL SYSTEM, CONTACT ALLIED METAL: (888) 520-8800
 TO PURCHASE ENGINEERED ESTOLGA ATTACHMENT SYSTEMS CONTACT WRISCO: (800) 753-8400
 TESTED TO ASTM E-330, ASTM E-331, ASTM E-283, AAMA-508
 PATENTED PRODUCTS 7.621.084, 084.02, 7.472.521, 521.02, 8.127.507, 8.015.917 PATENT PENDING, DESIGN PATENT PENDING

Confidential Document: Property of ALLIED. Any transfer of this document without the express written permission of ALLIED is unlawful. This document includes: Originals, duplicates, and electronic versions. All are exclusive. Information contained herein or related hereto is intended only for evaluation by technically skilled persons, with any use thereof to be at their independent discretion and risk. Such information is believed to be reliable, but ALLIED shall have no responsibility or liability for results obtained or damages resulting from such use. ALLIED grants no license under, and shall have no responsibility or liability for infringement of, any patent proprietary right. Sales of ALLIED products shall be independent and subject exclusively to warranties set forth in ALLIED acknowledgment. The foregoing may be waived or modified only in writing by an ALLIED officer.

CONTRACTOR NOTE:
 ALL WALLS ARE TO BE PLUMB
 & LEVEL. INSTALLER TO USE
 NECESSARY SHIMS IF WALLS
 ARE NOT PLUMB OR LEVEL.
 SHIMS (NOT BY ESTOLGA)

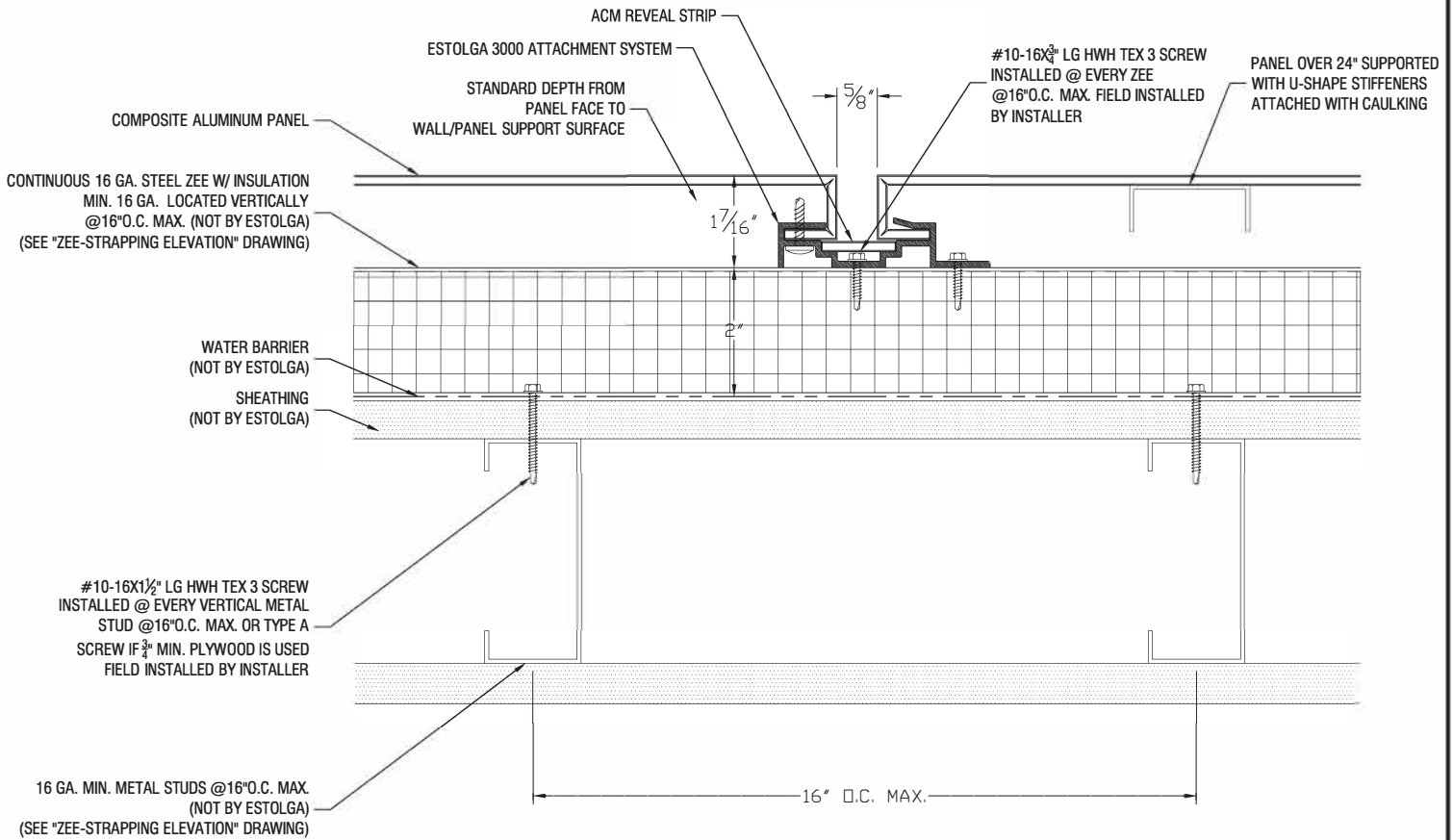

Typical Vertical Joint Detail

ESTOLGA 3000 AAMA 508 PRESSURE EQUALIZED RAINDRAIN SYSTEM (SYSTEM INSTALLED ON CONTINUOUS ZEE W/ INSULATION)

TO PURCHASE ENGINEERED/FABRICATED PANEL SYSTEM, CONTACT ALLIED METAL: (888) 520-8800

TO PURCHASE ENGINEERED ESTOLGA ATTACHMENT SYSTEMS CONTACT WRISCO: (800) 753-8400

TESTED TO ASTM E-330, ASTM E-331, ASTM E-283, AAMA-508

PATENTED PRODUCTS 7.621.084, 084.02, 7.472.521, 521.02, 8.127.507, 8.015.917 PATENT PENDING, DESIGN PATENT PENDING



ALLIED[®]
 SPECIALTY GROUP

CONTRACTOR NOTE:
 ALL WALLS ARE TO BE PLUMB
 & LEVEL. INSTALLER TO USE
 NECESSARY SHIMS IF WALLS
 ARE NOT PLUMB OR LEVEL.
 SHIMS (NOT BY ESTOLGA)

16 GA. MIN. METAL STUDS @16"O.C. MAX.
 (NOT BY ESTOLGA)
 (SEE "ZEE-STRAPPING ELEVATION" DRAWING)

#10-16x1½" LG HWH TEX 3 SCREW
 INSTALLED @ EVERY VERTICAL METAL
 STUD @16"O.C. MAX. OR TYPE A
 SCREW IF ¾" MIN. PLYWOOD IS USED
 FIELD INSTALLED BY INSTALLER

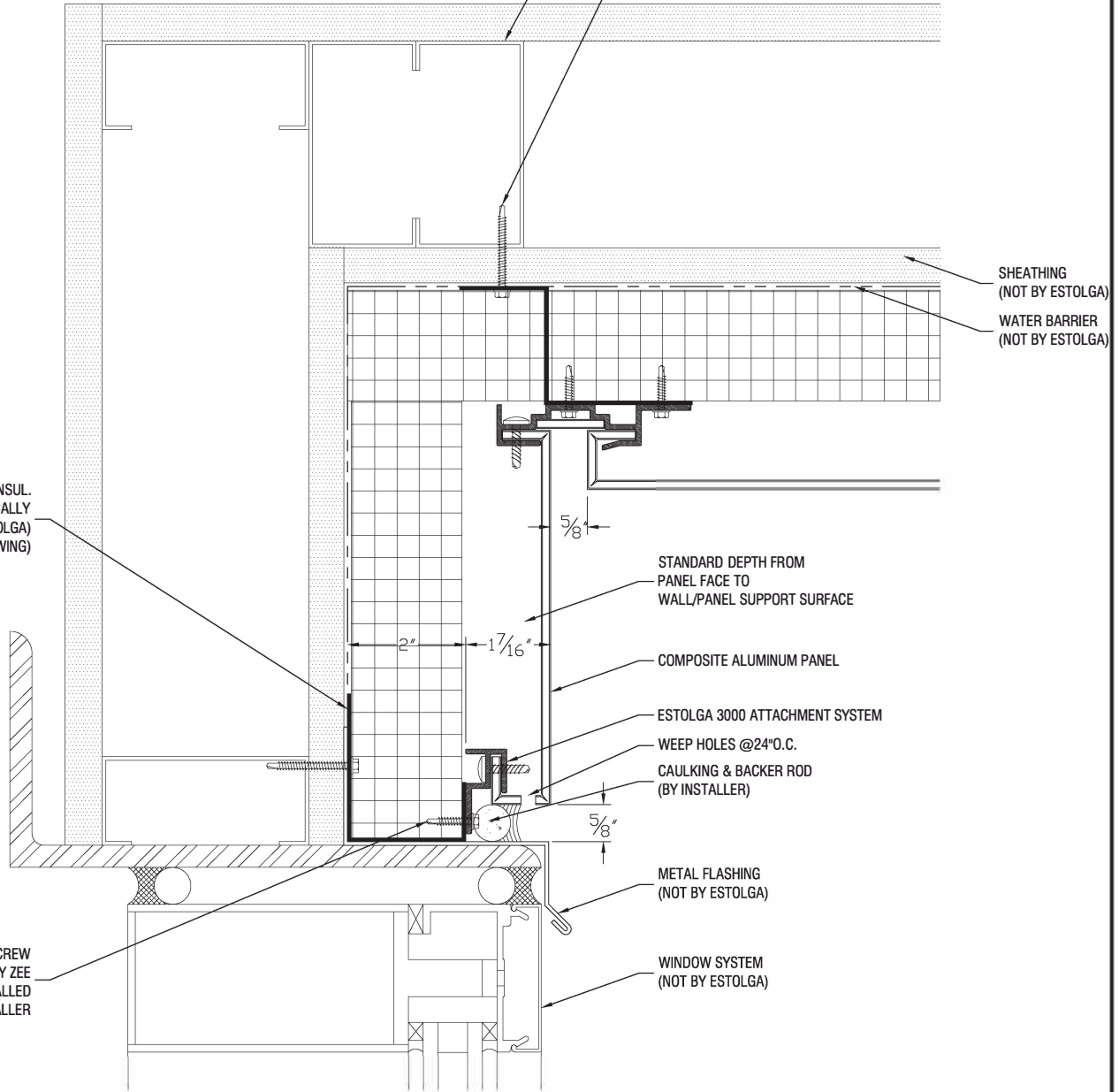

CONTINUOUS 16 GA. STEEL CHANNEL W/ INSUL.
 MIN. 16 GA. LOCATED VERTICALLY
 @16"O.C. MAX. (NOT BY ESTOLGA)
 (SEE "ZEE-STRAPPING ELEVATION" DRAWING)

SHEATHING
 (NOT BY ESTOLGA)
 WATER BARRIER
 (NOT BY ESTOLGA)

STANDARD DEPTH FROM
 PANEL FACE TO
 WALL/PANEL SUPPORT SURFACE

COMPOSITE ALUMINUM PANEL

ESTOLGA 3000 ATTACHMENT SYSTEM

WEEP HOLES @24"O.C.

CAULKING & BACKER ROD
 (BY INSTALLER)

METAL FLASHING
 (NOT BY ESTOLGA)

WINDOW SYSTEM
 (NOT BY ESTOLGA)

#10-16x½" LG HWH TEX 3 SCREW
 INSTALLED @ EVERY ZEE
 @16"O.C. MAX. FIELD INSTALLED
 BY INSTALLER

Canopy Detail

ESTOLGA 3000 AAMA 508 PRESSURE EQUALIZED RAINDRAIN SYSTEM (SYSTEM INSTALLED ON CONTINUOUS ZEE W/ INSULATION)

TO PURCHASE ENGINEERED/FABRICATED PANEL SYSTEM, CONTACT ALLIED METAL: (888) 520-8800

TO PURCHASE ENGINEERED ESTOLGA ATTACHMENT SYSTEMS CONTACT WRISCO: (800) 753-8400

TESTED ■ ASTM E-330, ASTM E-331, ASTM E-283, AAMA-508

PATENTED PRODUCTS 7.621.084, 084.82, 7.472.521, 521.82, 8.127.507, 8.015.917 PATENT PENDING, DESIGN PATENT PENDING



ALLIED[®]
 SPECIALTY GROUP

CONTRACTOR NOTE:
 ALL WALLS ARE TO BE PLUMB
 & LEVEL. INSTALLER TO USE
 NECESSARY SHIMS IF WALLS
 ARE NOT PLUMB OR LEVEL.
 SHIMS (NOT BY ESTOLGA)

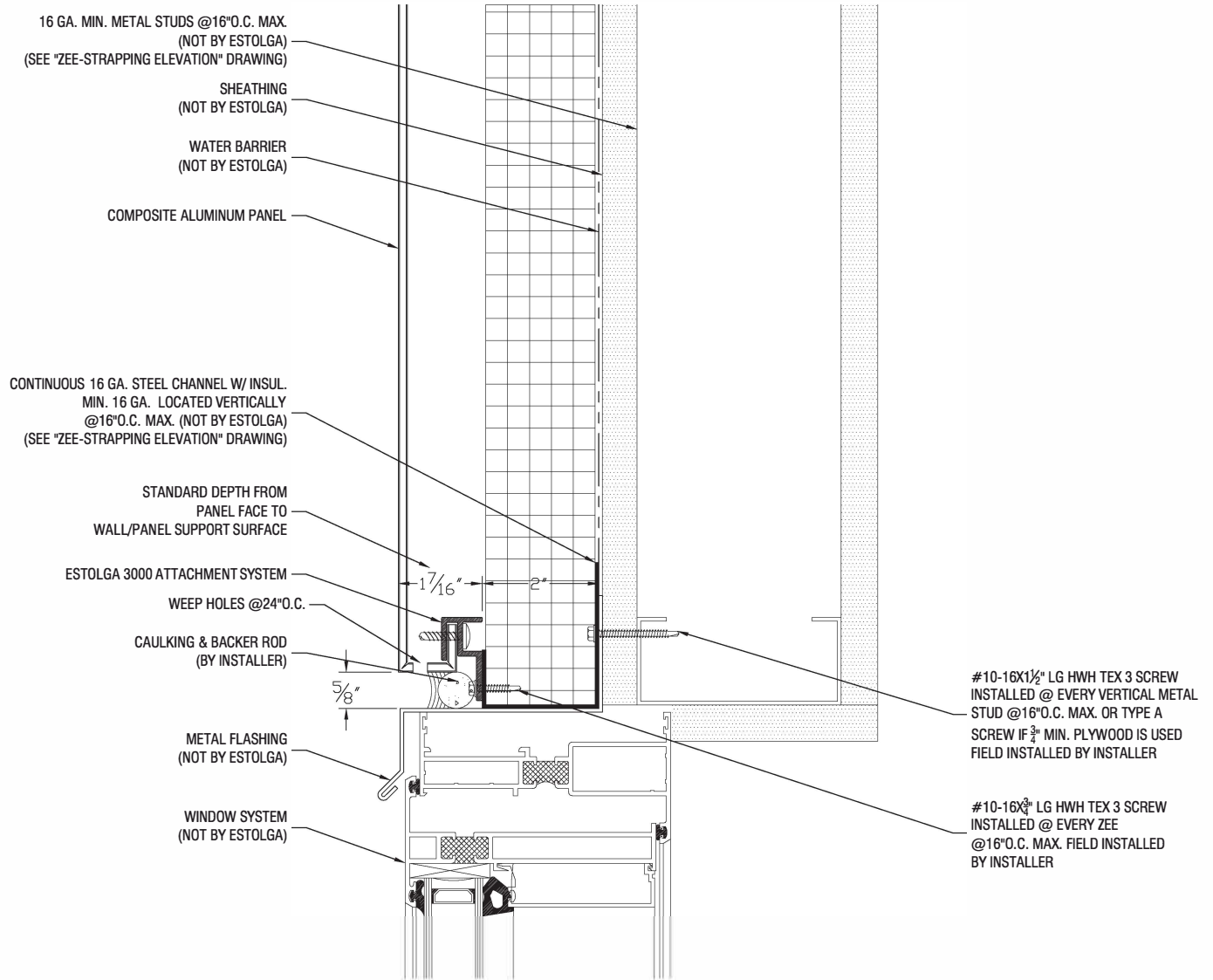

Window Head Detail

ESTOLGA 3000 AAMA 508 PRESSURE EQUALIZED RAINSCREEN SYSTEM (SYSTEM INSTALLED ON CONTINUOUS ZEE W/ INSULATION)

TO PURCHASE ENGINEERED/FABRICATED PANEL SYSTEM, CONTACT ALLIED METAL: (888) 520-8800

TO PURCHASE ENGINEERED ESTOLGA ATTACHMENT SYSTEMS CONTACT WRISCO: (800)753-8400

TESTED ■ ASTM E-330, ASTM E-331, ASTM E-283, AAMA-508

PATENTED PRODUCTS 7.621.084, 084 B2, 7.472.521, 521 B2, 8.127.507, 8.015.917 PATENT PENDING, DESIGN PATENT PENDING



ALLIED[®]
 SPECIALTY GROUP

CONTRACTOR NOTE:
 ALL WALLS ARE TO BE PLUMB
 & LEVEL. INSTALLER TO USE
 NECESSARY SHIMS IF WALLS
 ARE NOT PLUMB OR LEVEL.
 SHIMS (NOT BY ESTOLGA)

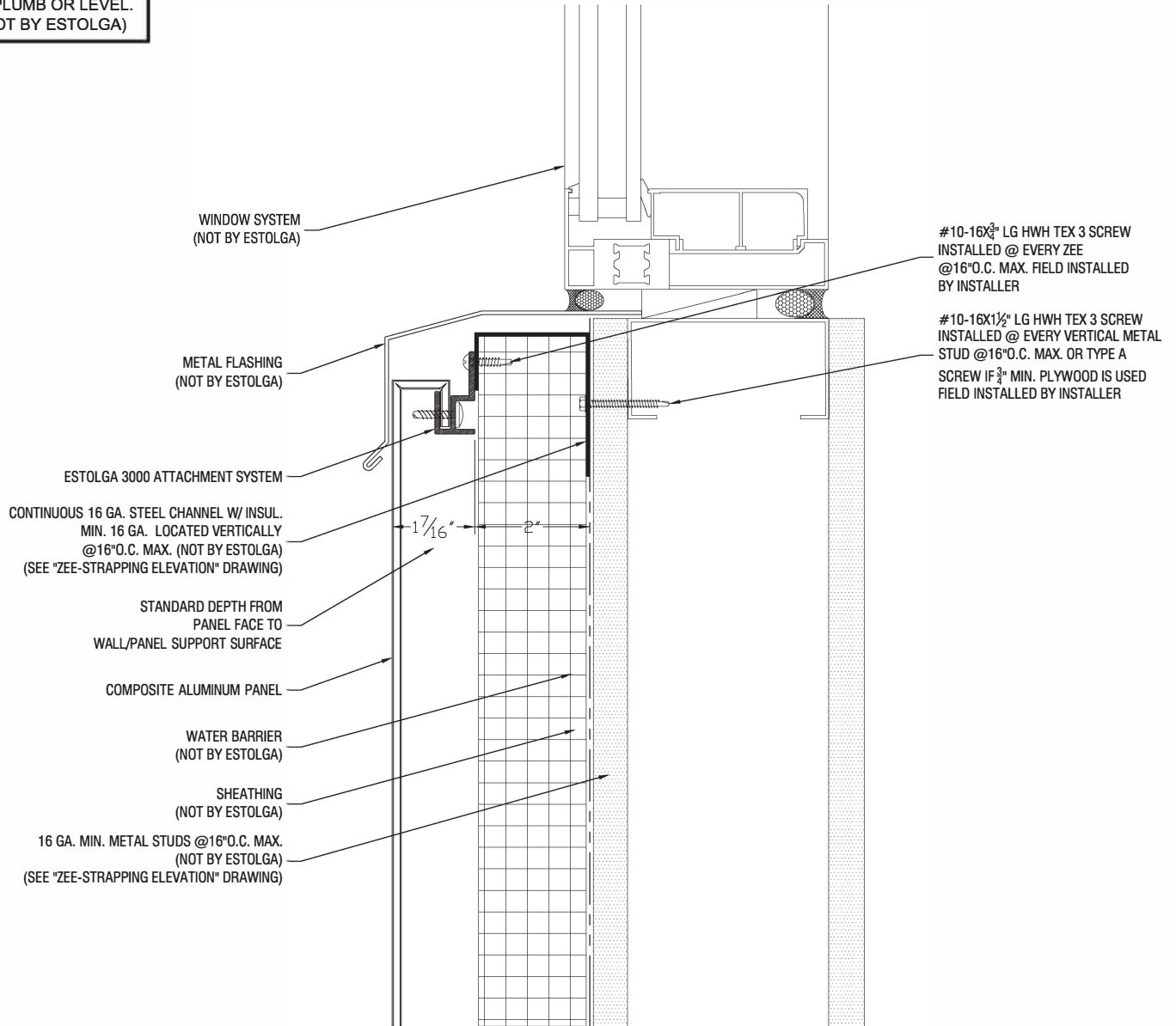

Window Sill Detail

ESTOLGA 3000 AAMA 508 PRESSURE EQUALIZED RAINSCREEN SYSTEM (SYSTEM INSTALLED ON CONTINUOUS ZEE W/ INSULATION)

TO PURCHASE ENGINEERED/FABRICATED PANEL SYSTEM, CONTACT ALLIED METAL: (888) 520-8800

TO PURCHASE ENGINEERED ESTOLGA ATTACHMENT SYSTEMS CONTACT WRISCO: (800)753-8400

TESTED ASTM E-330, ASTM E-331, ASTM E-283, AAMA-508

PATENTED PRODUCTS 7.621.084, 084 B2, 7.472.521, 521 B2, 8.127.507, 8.015.917 PATENT PENDING, DESIGN PATENT PENDING



ALLIED[®]
 SPECIALTY GROUP

CONTRACTOR NOTE:
 ALL WALLS ARE TO BE PLUMB
 & LEVEL. INSTALLER TO USE
 NECESSARY SHIMS IF WALLS
 ARE NOT PLUMB OR LEVEL.
 SHIMS (NOT BY ESTOLGA)

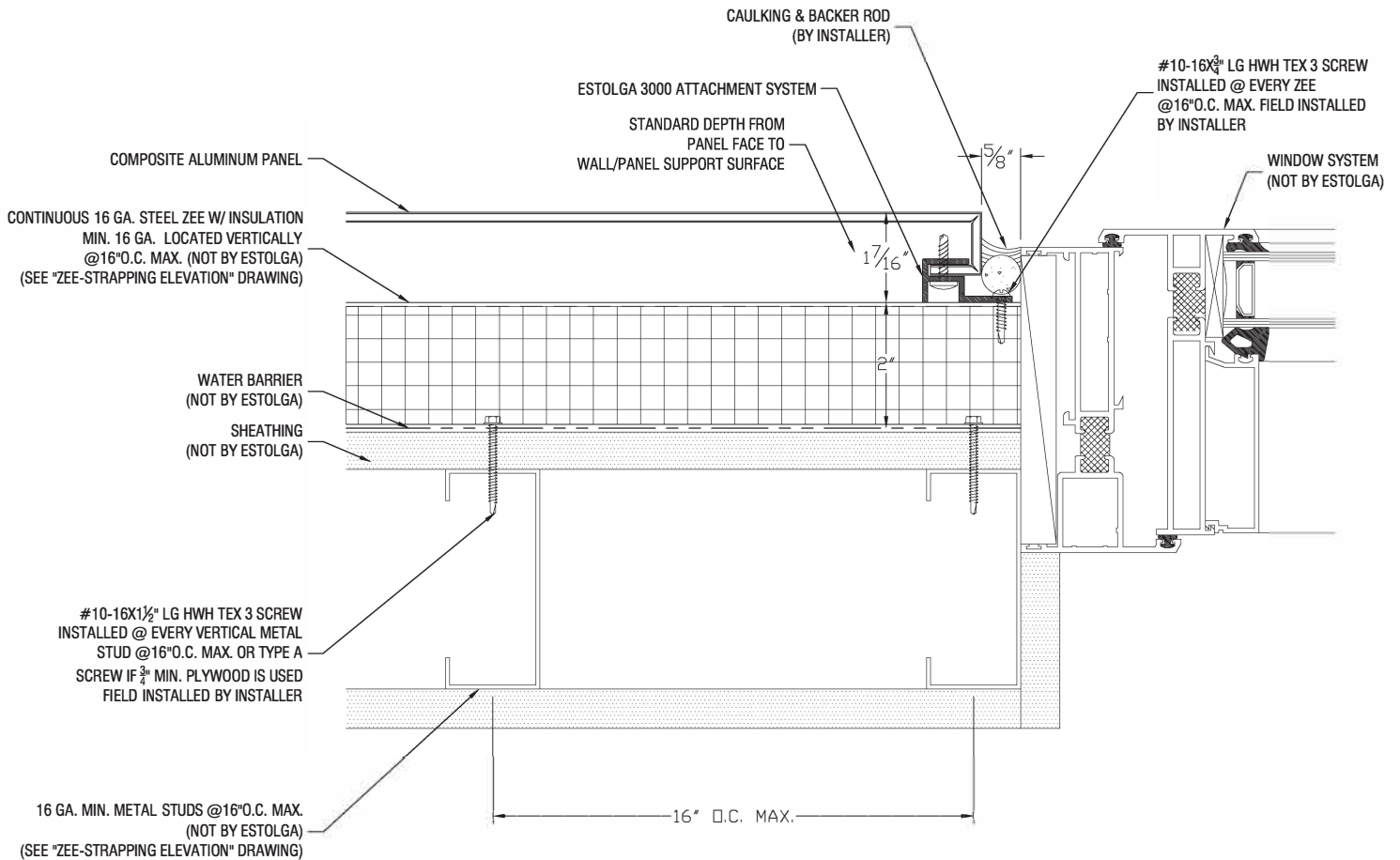

Window Jamb Detail

ESTOLGA 3000 AAMA 508 PRESSURE EQUALIZED RAINDRAIN SYSTEM (SYSTEM INSTALLED ON CONTINUOUS ZEE W/ INSULATION)

TO PURCHASE ENGINEERED/FABRICATED PANEL SYSTEM, CONTACT ALLIED METAL: (888) 520-8800

TO PURCHASE ENGINEERED ESTOLGA ATTACHMENT SYSTEMS CONTACT WRISCO: (800) 753-8400

TESTED ■ ASTM E-330, ASTM E-331, ASTM E-283, AAMA-508

PATENTED PRODUCTS 7.621.084, 084.02, 7.472.521, 521.02, 8.127.507, 8.015.917 PATENT PENDING, DESIGN PATENT PENDING



ALLIED[®]
 SPECIALTY GROUP

CONTRACTOR NOTE:
 ALL WALLS ARE TO BE PLUMB
 & LEVEL. INSTALLER TO USE
 NECESSARY SHIMS IF WALLS
 ARE NOT PLUMB OR LEVEL.
 SHIMS (NOT BY ESTOLGA)

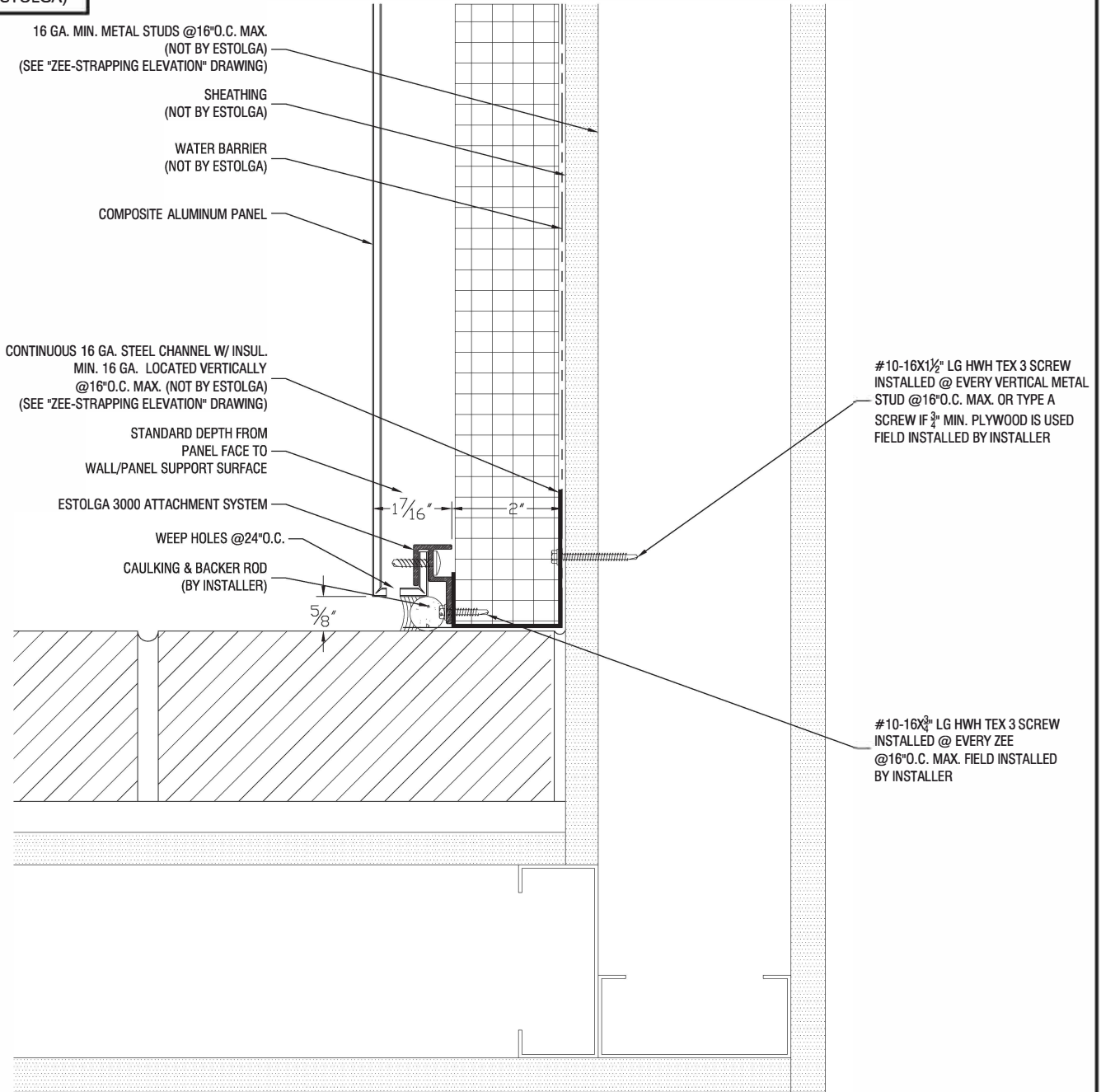

Plan Detail @ Adjacent Wall

**ESTOLGA 3000 AAMA 508 PRESSURE
 EQUALIZED RAINDRAIN SYSTEM
 (SYSTEM INSTALLED ON CONTINUOUS ZEE W/ INSULATION)**

TO PURCHASE ENGINEERED/FABRICATED PANEL SYSTEM, CONTACT ALLIED METAL: (888) 520-8800

TO PURCHASE ENGINEERED ESTOLGA ATTACHMENT SYSTEMS CONTACT WRISCO: (800)753-8400

TESTED ASTM E-330, ASTM E-331, ASTM E-283, AAMA-508

PATENTED PRODUCTS 7.621.084, 084.02, 7.472.521, 521.02, 8.127.507, 8.015.917 PATENT PENDING, DESIGN PATENT PENDING



ALLIED[®]
 SPECIALTY GROUP

CONTRACTOR NOTE:
 ALL WALLS ARE TO BE PLUMB
 & LEVEL. INSTALLER TO USE
 NECESSARY SHIMS IF WALLS
 ARE NOT PLUMB OR LEVEL.
 SHIMS (NOT BY ESTOLGA)

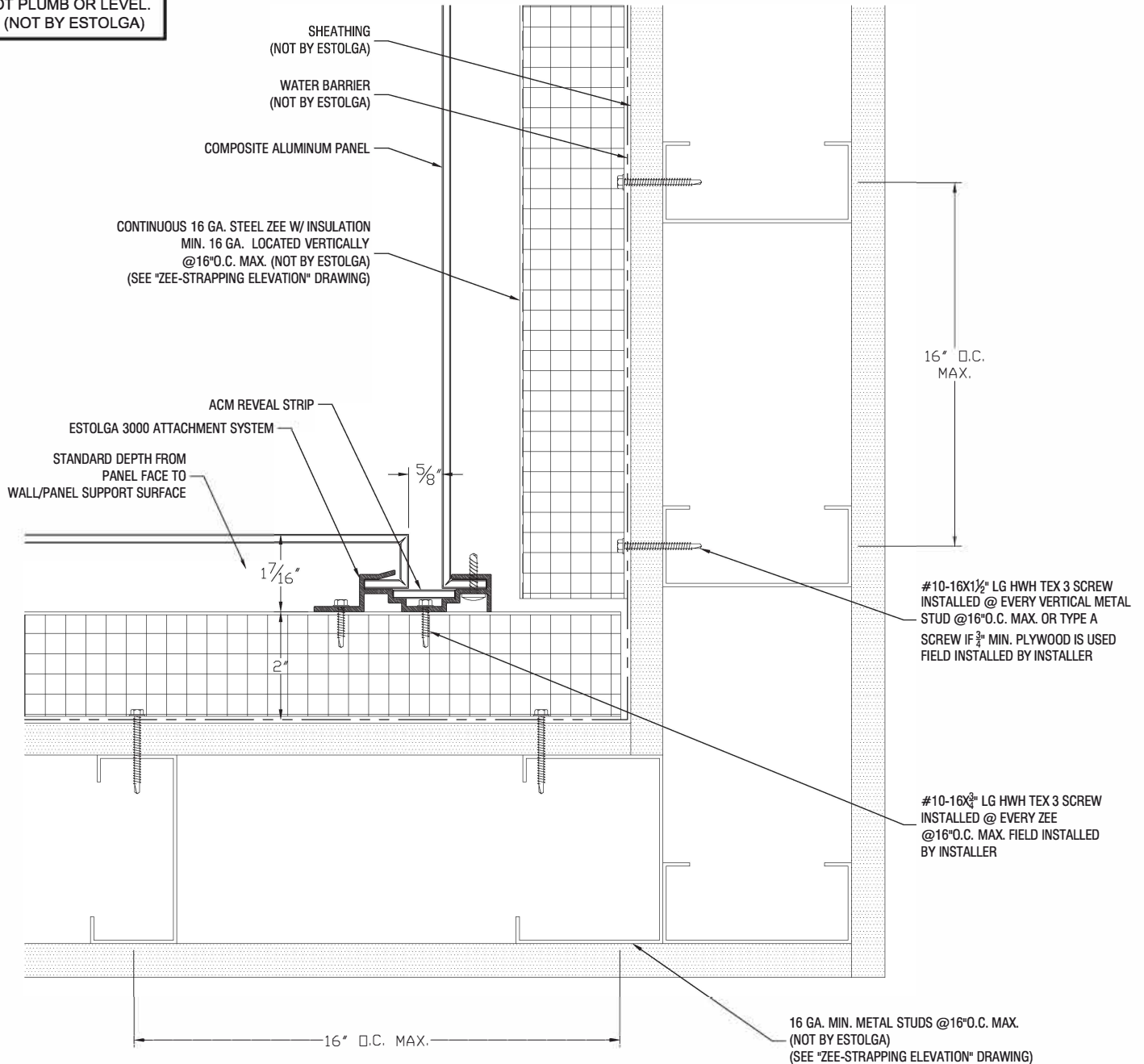

Inside Corner Detail

**ESTOLGA 3000 AAMA 508 PRESSURE
 EQUALIZED RAINSCREEN SYSTEM
 (SYSTEM INSTALLED ON CONTINUOUS ZEE W/ INSULATION)**

TO PURCHASE ENGINEERED/FABRICATED PANEL SYSTEM, CONTACT ALLIED METAL: (888) 520-8800

TO PURCHASE ENGINEERED ESTOLGA ATTACHMENT SYSTEMS CONTACT WRISCO: (800)753-8400

TESTED ■ ASTM E-330, ASTM E-331, ASTM E-283, AAMA-508

PATENTED PRODUCTS 7.621.084, 084 B2, 7.472.521, 521 B2, 8.127.507, 8.015.917 PATENT PENDING. DESIGN PATENT PENDING



ALLIED[®]
 SPECIALTY GROUP

CONTRACTOR NOTE:
 ALL WALLS ARE TO BE PLUMB
 & LEVEL. INSTALLER TO USE
 NECESSARY SHIMS IF WALLS
 ARE NOT PLUMB OR LEVEL.
 SHIMS (NOT BY ESTOLGA)

#10-16X1½" LG HWH TEX 3 SCREW
 INSTALLED @ EVERY VERTICAL METAL
 STUD @16"O.C. MAX. OR TYPE A
 SCREW IF ¾" MIN. PLYWOOD IS USED
 FIELD INSTALLED BY INSTALLER

#10-16X¾" LG HWH TEX 3 SCREW
 INSTALLED @ EVERY ZEE
 @16"O.C. MAX. FIELD INSTALLED
 BY INSTALLER

16" O.C.
 MAX.

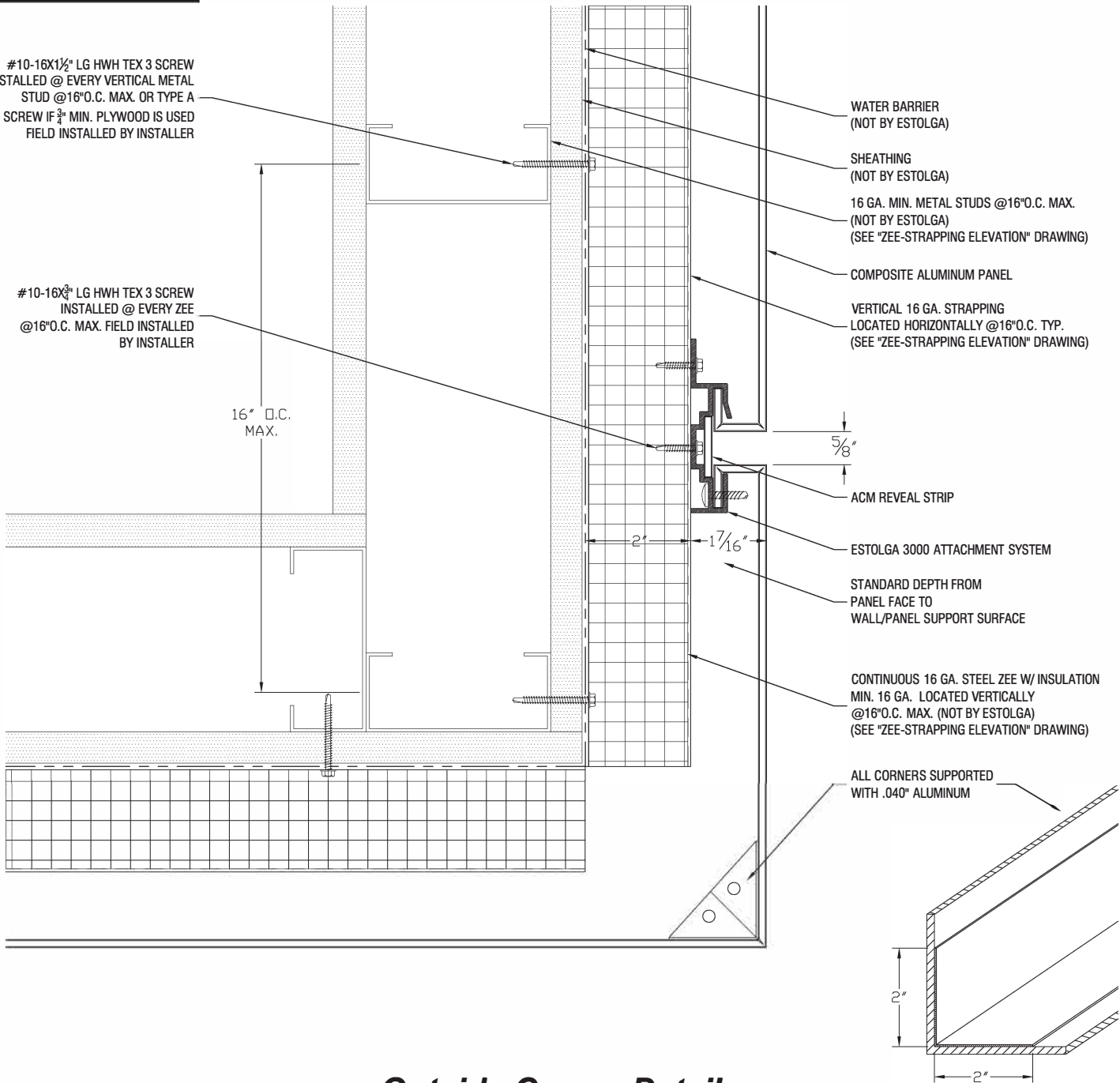

Outside Corner Detail

**ESTOLGA 3000 AAMA 508 PRESSURE
 EQUALIZED RAINSCREEN SYSTEM
 (SYSTEM INSTALLED ON CONTINUOUS ZEE W/ INSULATION)**

TO PURCHASE ENGINEERED/FABRICATED PANEL SYSTEM, CONTACT ALLIED METAL: (888) 520-8800

TO PURCHASE ENGINEERED ESTOLGA ATTACHMENT SYSTEMS CONTACT WRISCO: (800) 753-8400

TESTED ■ ASTM E-330, ASTM E-331, ASTM E-283, AAMA-508

PATENTED PRODUCTS 7.621.084, 084 B2, 7.472.521, 521 B2, 8.127.507, 8.015.917 PATENT PENDING, DESIGN PATENT PENDING



ALLIED[®]
 SPECIALTY GROUP

CONTRACTOR NOTE:
 ALL WALLS ARE TO BE PLUMB
 & LEVEL. INSTALLER TO USE
 NECESSARY SHIMS IF WALLS
 ARE NOT PLUMB OR LEVEL.
 SHIMS (NOT BY ESTOLGA)

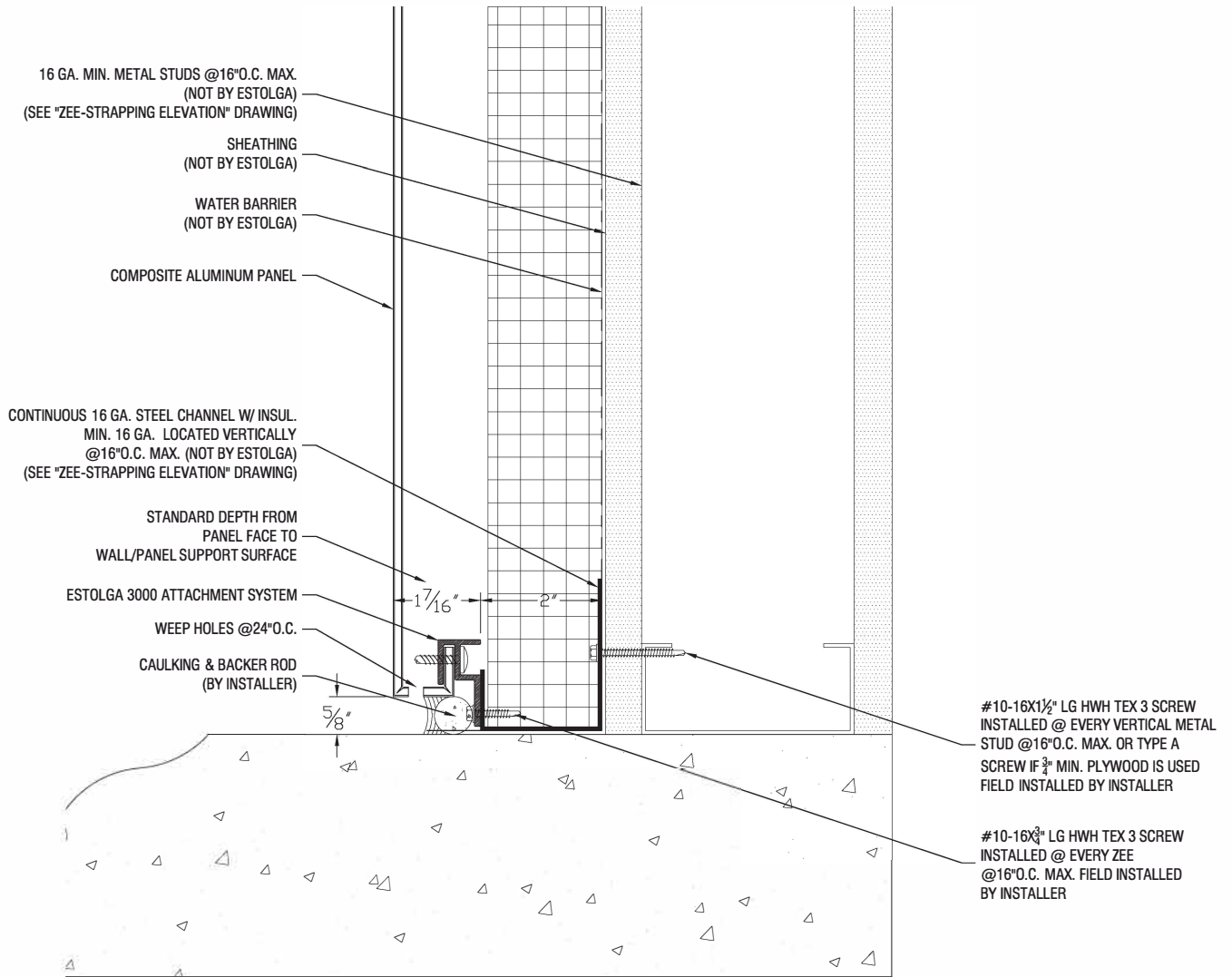

Base Detail

**ESTOLGA 3000 AAMA 508 PRESSURE
 EQUALIZED RAINDRIP SYSTEM
 (SYSTEM INSTALLED ON CONTINUOUS ZEE W/ INSULATION)**

TO PURCHASE ENGINEERED/FABRICATED PANEL SYSTEM, CONTACT ALLIED METAL: (888) 520-8800

TO PURCHASE ENGINEERED ESTOLGA ATTACHMENT SYSTEMS CONTACT WRISCO: (800)753-8400

TESTED ■ ASTM E-330, ASTM E-331, ASTM E-283, AAMA-508

PATENTED PRODUCTS 7.621.084, 084.02, 7.472.521, 521.02, 8.127.507, 8.015.917 PATENT PENDING, DESIGN PATENT PENDING



ALLIED[®]
 SPECIALTY GROUP

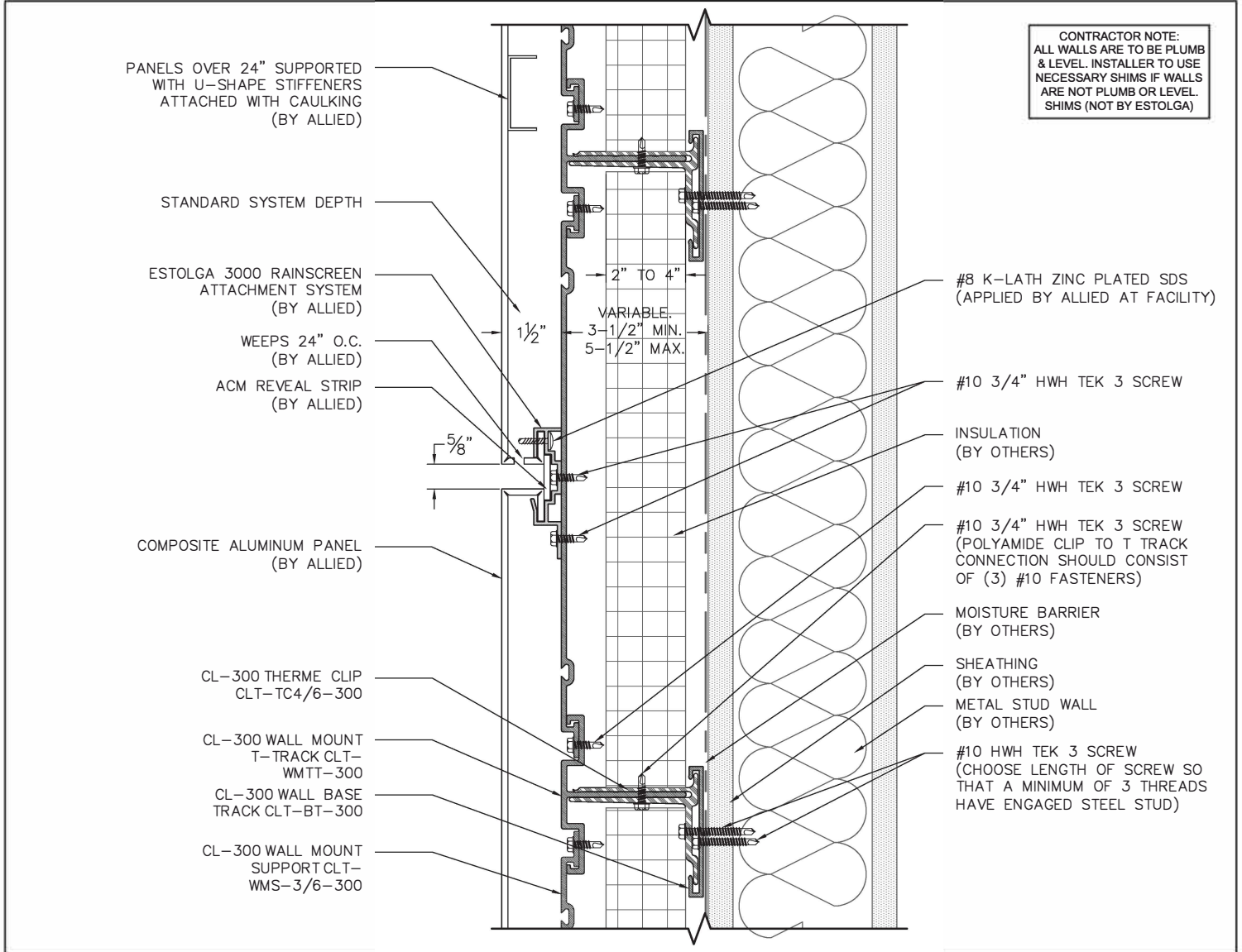

Typical Horizontal Joint Detail

ESTOLGA® 3000 Rainscreen System with CL-300 Cladding Support System
TESTED: AAMA-508, NFPA-285, ASTM E-283, ASTM E-330, and ASTM E-331



ALLIED®
SPECIALTY GROUP